

DC High-efficiency Backward Curved Centrifugal Fan

Erp2015  
EXCEEDS THE NORM

Motorized Backward Curved Impeller (24V & 48V)



Φ 190

Rotor Material: Carbon steel  
Impeller Material: Plastic  
Ingress Protection: IP42  
Insulation Class: F  
Bearing Type: Maintenance free ball bearing

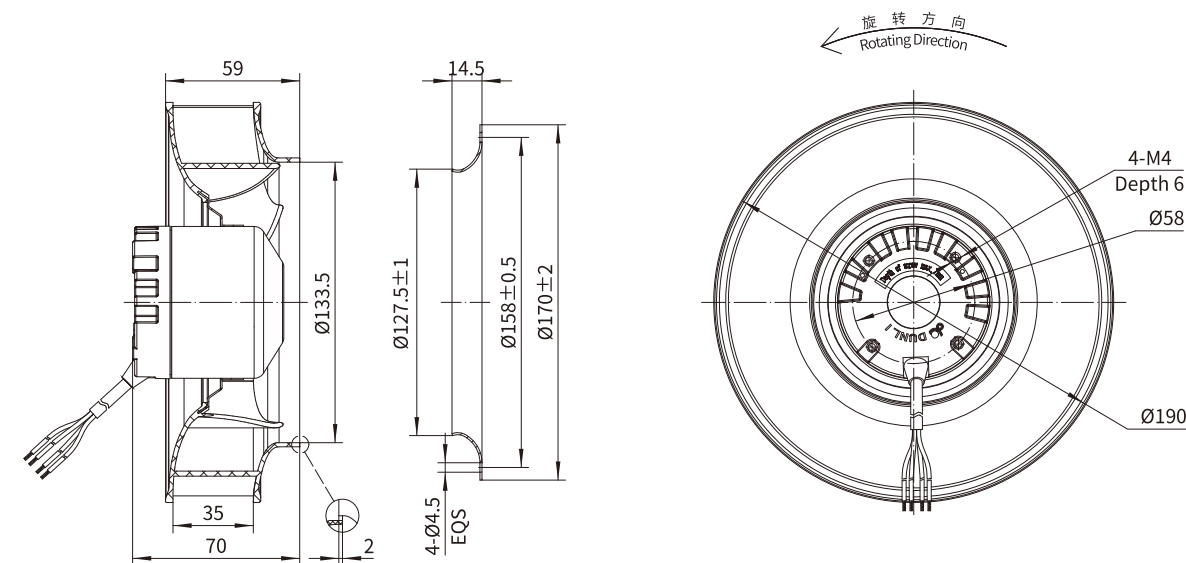

Performance Curves

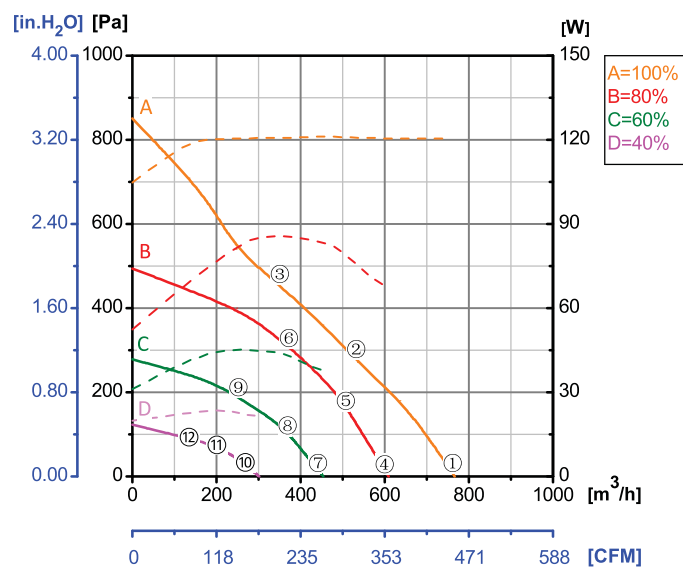

Test Point	Speed	Input Power
	rpm	W
1	3996	120
2	3613	120
3	3591	120
4	3193	68
5	3196	78
6	3193	86
7	2396	38
8	2398	43
9	2397	45
10	1599	21
11	1598	22
12	1599	23

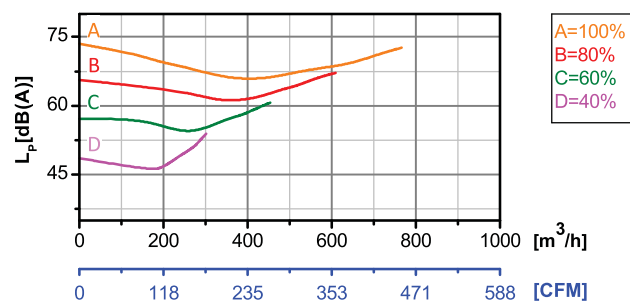

Erp2015 Data:  
Efficiency  $\eta_{statA} = \% < 125W$   
Efficiency grade  $N_{actual} = \%, N_{target} = 62$   
Test report NO.: L-20210302-005-107

Motorized Backward Curved Impeller (310V)

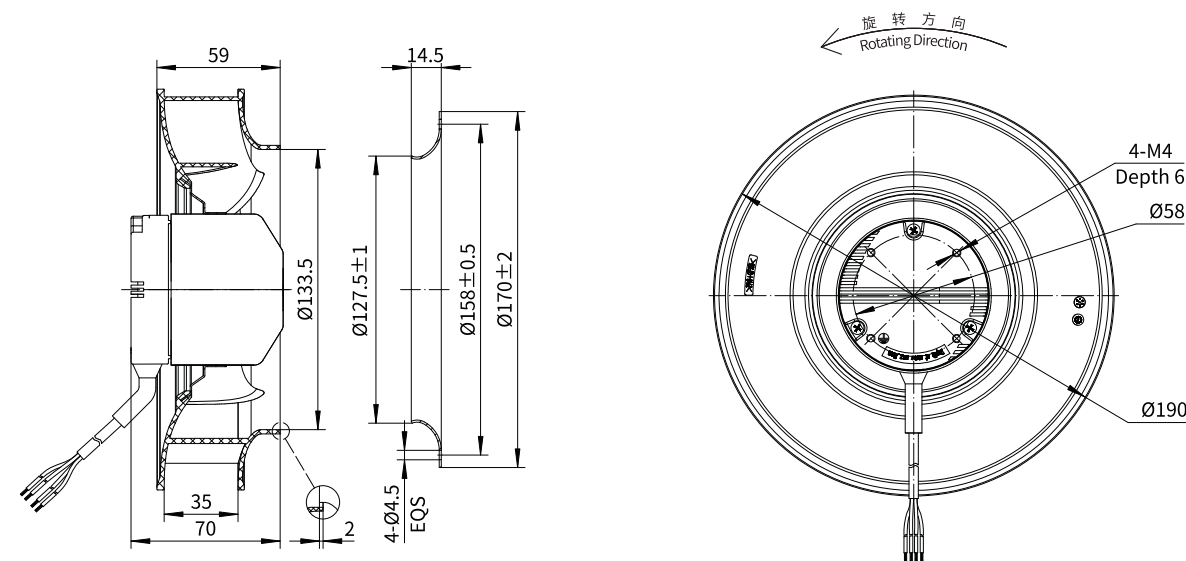

Model No.	Voltage	Frequency	Speed	Input Power	Current	Working Temp.	APProvals
	VAC	Hz	RPM	W	A	Min/Max (°C)	
DC72-B190-A01	24	/	4000	120	5.00	-20/+60	CE
DC72-B190-C01	48	/	4000	120	2.50	-20/+60	CCC,CE
DC72-B190-D10	310	/	4000	120	0.39	-20/+60	CCC,CE